



C o n t e n t s

welters *world* - a Government *WORLD* supplement

Burial Chamber Installations
Burial Chamber Installations
Burial Chamber Installations
Phase 10 Burial Chambers
Muslim Burial Sections
Muslim Burial Sections
Single Chamber Installations
Stone Memorial Orbs
Land Reclamation
Family Mausolea
Mausoleum Courtyard
New Family Mausoleum Design
New Family Mausoleum Design
New Family Mausoleum Design
Standing Stones
Niche Wall Polygon Tower
Chiltern Stone and Timber Bench
Chiltern Stone and Granite Bench
Inscription and Signage Services
Manufacturing

Whilst every effort has been made to ensure the accuracy of all articles, advertisements and other insertions in this publication, the publisher can accept no responsibility for any errors or omissions or incorrect insertions. The views of the contributors are not necessarily those of the publisher or the advertisers. The publisher makes no warranties, claims or guarantees in regard to accuracy, completeness or currency of information and cannot accept any liability resulting from the use or misuse of any such information. The Publisher does not accept responsibility for mistakes, be they editorial or typographical, nor for consequences resulting from them.

welters[®]
ORGANISATION
WORLDWIDE

Visit us on-line at
government-world.com

- 2 Advertising | Articles | News |
3 Letters | Editorials
4
5 **welters organisation**
6 P.O. Box 159 Carlisle, Great Britain CA2 5BG
7 Office: 08702 416 422
8 Fax: 01228 674 959
9 E-mail: office@government-world.com
10
11 Submissions should be sent to **Government WORLD**,
12 PO Box 159, Carlisle, CA2 5BG
13 Tel: 08702 416 422 Fax: 01228 674 959
14 Email: submissions@government-world.com
15
16
17
18
19
20
21
22

ISSN 1744-6996



Cover picture:
welters Standing Stones

Cemetery Village® Phasing



Burial Chamber Installations

As part of a multi-phase installation a further 18 burial chambers with associated memorial housings in a combination of granite and decorative stone have been installed. This is an ongoing service to a large Local Authority and the latest installation will be finished off with the addition of tarmac pathways.



Cemetery Village® Phasing



Burial Chamber Installations

Phase One of twenty chambers where installed for a Burial Authority in the Midlands. The project is part of a multi-phased development on newly reclaimed land within the cemetery and included the provision of granite memorial housings, pathways and drainage.





Burial Chamber Installations

welters® have been consulted by a major Scottish Burial Authority to provide burial chambers and associated memorial housing systems to complete a phase of a large cemetery development on land that was previously unsuitable for earthen burial due to high water tables.



Cemetery Village® Phasing



Phase 10 Burial Chambers

In continuation of our long standing service provision to a large London Burial Authority spanning over 16 years, **welters®** have recently completed Phase 10 consisting of 58 burial chambers with memorial housings and associated resin bound pathways.



Cemetery Village® Phasing

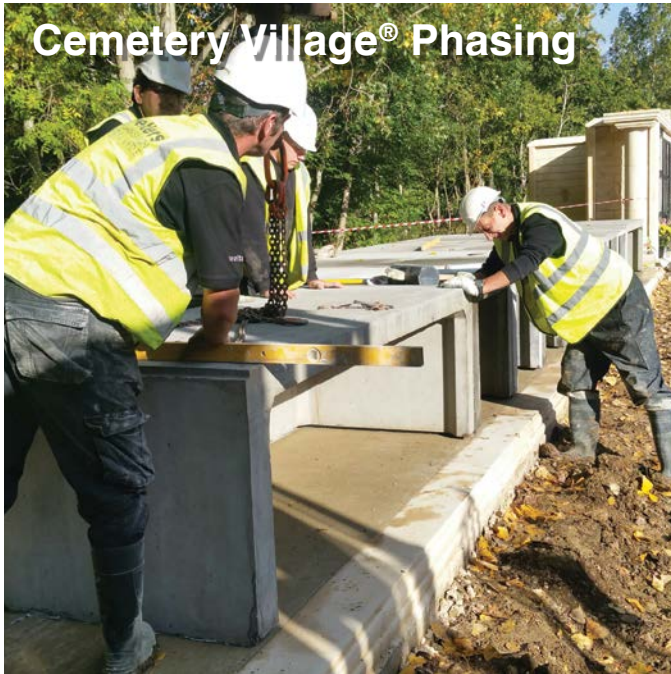

Contract Extended

welters® have received an extension to their current contract and continue to provide products and services to a large Midlands Burial Authority.

These products and services include the supply and installation of community and family mausolea and burial chambers and associated memorial products.





Muslim Burial Sections

welters® provide Muslim chambers to many Burial Authorities across the nation. This primarily is in the supply and installation of single interment vaults, although in recent times, as burial land becomes more precious, there is a growing interest in the provision of family double chambers.





Muslim Burial Sections
welters® installed two further phases of Muslim burial chambers in separate cemeteries for a Midlands Burial Authority.

This is a continuation of a long term provision of facilities for Muslim Communities served by the Council.





Single Chamber Installations

Quite often **welters®** will be called upon to install a single chamber for a private grave. This type of installation is usually at short notice due to the death of a family member and typically a team will be sent to prepare the chamber for the pending interment and be on hand to seal it up afterwards.



Stone Memorial Orbs



welters® Stone Memorial Orbs continue to be a successful alternative to the traditional above ground niche interment facility. The Orbs are equally suitable in a formal or natural setting and available with a range of associated products.





Land Reclamation

The project included the clearance, levelling and grading out of a disused and overgrown area of land within a London cemetery in preparation of earthen grave burials. Pathways were then installed and the area will receive a final layer of topsoil prior to seeding out.

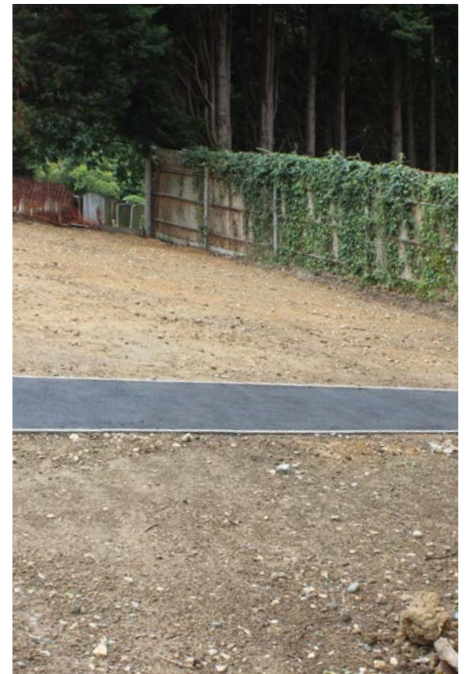

Family Mausolea

welters® have recently introduced a new exclusive design to their range of family mausolea. The design is available for two or four interments, blending traditional and modern styling in an attractive monument.



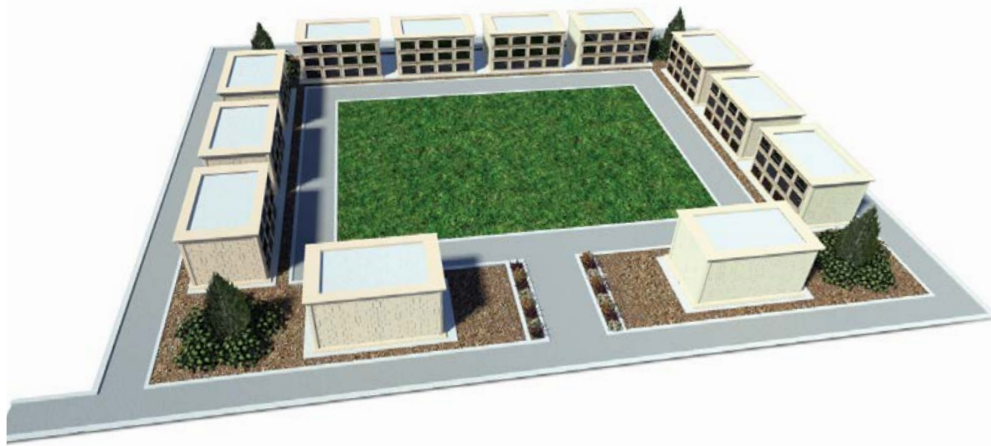

Mausoleum Courtyard

This newly awarded contract includes the installation of 12 community mausoleum units within a courtyard arrangement for a North London Burial Authority.

The courtyard will include hard and soft landscaping and a possible burial chamber installation within the central area.



New Family Mausoleum Design

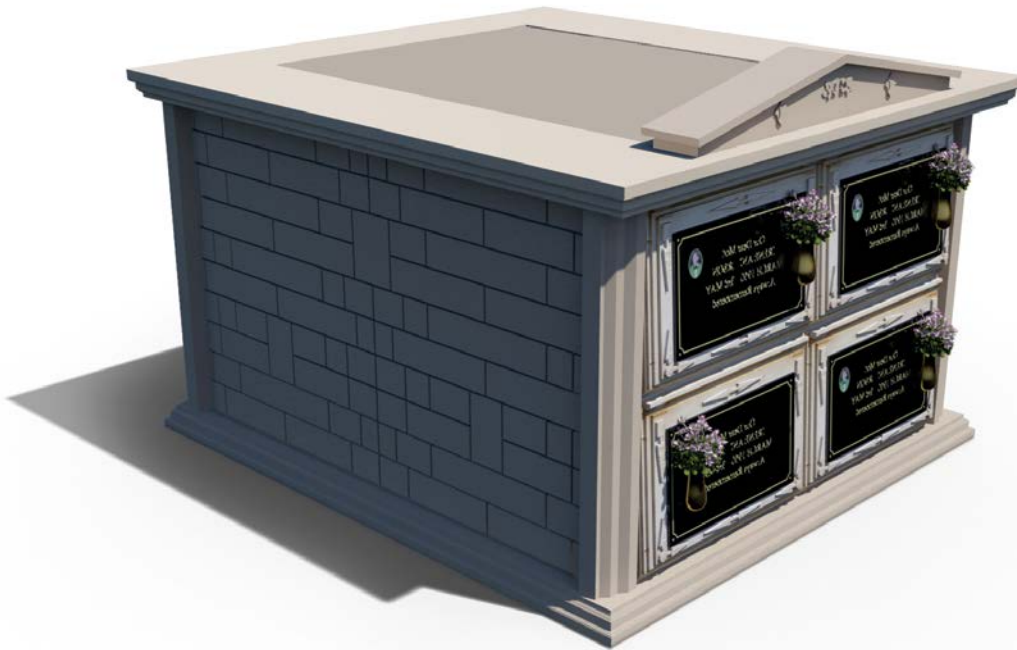

welters[®]

ORGANISATION WORLDWIDE Design and Innovation Four Interment Mausoleum

Family mausoleum for four interments comprising of:

- Architectural decorative base plinth set on a concrete foundation
- Precast concrete interment cell super-structure
- Decorative stone corner posts
- Natural stone cladding to sides and rear
- Decorative 900 front tablets
- Decorative stone pediment with fleur-de-lis

The mausoleum will be fitted with blank granite tablets. The granite front tablet inscriptions and bronze ornaments shown here are examples for display purposes only and not included in the specification. All inscription work and bronzes selections will be made and quoted for separately at the time of need after the installation is complete.

New Family Mausoleum Design

welters[®]
ORGANISATION
WORLDWIDE
Design and Innovation

Family Mausoleum

Design Option 1

Family mausoleum for four interments comprising of:

- Decorative stone base plinth set on a concrete foundation
- Precast concrete interment cell super-structure
- Decorative stone corner posts and columns
- Natural stone cladding to sides and rear
- Decorative stone roof



Image shown is for illustration purpose only. Actual product may vary due to product enhancement

New Family Mausoleum Design

welters[®]
ORGANISATION
WORLDWIDE
Design and Innovation

Family Mausoleum

Design Option 2

Family mausoleum for four interments comprising of:

- Decorative stone base plinth set on a concrete foundation
- Precast concrete interment cell super-structure
- Decorative stone corner posts and columns
- Natural stone cladding to sides and rear
- Decorative stone apex roof assembly



Image shown is for illustration purpose only. Actual product may vary due to product enhancement



Standing Stones

The Standing Stones are manufactured by hand and each one is unique in form. The Stones can be used as a landscaped feature or memorialised to generate a revenue stream for the Burial Authority. The stones pictured are to be installed in the grounds of a South Coast crematorium



Niche Wall Polygon Tower

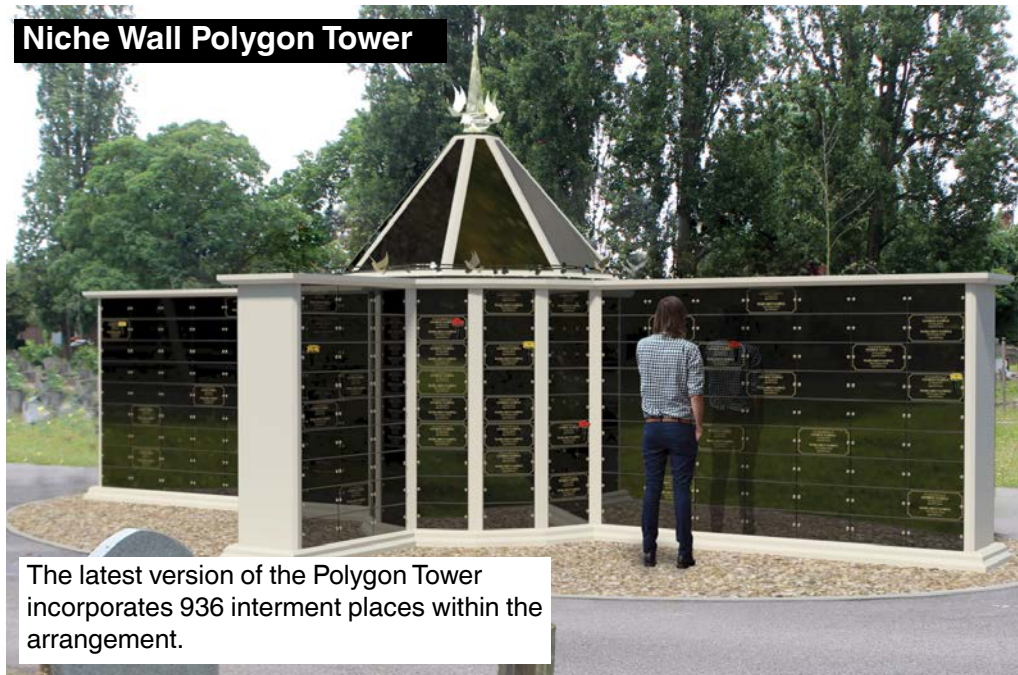



Module 1



Module 2



Module 3

Chiltern Stone and Timber Bench

The new Chiltern Timber Memorial Bench is now available in a range of five modules that include memorial plaques and cremation niches.

The bench is manufactured using sustainable resources and replenishable stock and is marketed as both a memorial bench and street furniture item.





Chiltern Stone and Granite Bench

The **welters®** Chiltern Memorial Bench provides a range of affordable solutions for commemorative and memorial seating arrangements.

The memorial bench collection includes a range of options beginning with the standard bench and plinth arrangement with two inscription plaques. Upgraded versions include end planters and extended base plinth.



Inscription and Signage Services

VOLERTI BENE È STATO FAC
DIMENTICARTI IMPOSSIBI
VIVA SAN VINCENZO FERRI

...ions, and
ver in my heart.
est love always,
x Derek xxxx
st in Peace

welters® inscription and signage service forms part of their support services package which is offered to clients and users of their products and systems.

Inscriptions can be applied to a range of materials including granite, stone and wood. Ornaments and photo plaques are also offered with this service.

Always
SUS
Omeo

Winter is on my head but
eternal Spring is in my heart



Manufacturing

Based just outside Carlisle near the M6 corridor, **welters®** manufacturing facility is well positioned to serve the UK with an ever growing range of products, from large items such as burial chambers and mausolea cells to the more decorative products and architectural features.

New products are continually being developed and produced.





Burial chambers adapted for communal baby graves with dividing compartments and memorial frame cover.

welters[®]

ORGANISATION
WORLDWIDE
Design and Innovation

PO Box 159, Carlisle,
Great Britain, CA2 5BG
Tel: 08702 416 422
Fax: 01228 674 959
www.welters-worldwide.com
admin@welters-worldwide.com